

AC55

ITEM	DESCRIPTION	PART NO.	Q'TY
1	Set Screw	AC01001	1
3	Shakeproof lock Washer	AC01003	7
4	Air Deflector	AC01004	1
5	Rear Valve Seat	AC55005	1
6	O-Ring	AC01006	2
7	Throttle Spring	AC01007	1
8	Throttle Spring Locator	AC01008	1
9	Throttle Valve Screw	AC01009	2
10	Valve Screw Washer	AC01010	2
11	O-Ring Support	AC01011	4
12	O-Ring	AC01012	4
13	O-Ring Center Support	AC01013	2
14	Throttle Valve Spacer	AC55014	1
15	Nut	AC55015	2
16	Front Valve Seat	AC55016	1
17	Throttle Stem	AC01017	1
18	Button Head Cap Screw	AC01018	4
20	Trigger Guard	AC01020	1
21	Flexloc Nut	AC50124	2
25	Screw	AC55025	2
27	Housing with Rubber	AC55027	1
28	Set Screw	AC01028	2
29	O-Ring	AC41029	1
30	Piston	AC41030	1
31	Cylinder Gasket	AC41031	1
32	Piston Stop Spacer	AC55032	1
35R	Side Plate (Right)	AC5535R	1
35L	Side Plate (Left)	AC5535L	1
36	Roll Pin	AC01036	5
37	Trigger	AC01037	1
39	Socket Head Cap Screw	AC55039	4
40	Upper Jaw	AC55040	1
41	Jaw Bushing	AC55041	2
43	Latch Pin Clip	AC01043	1
44	Latch Spring	AC55044	1
45	Latch	AC55045	1
46	Roller	AC55046	4
47	Feeder Blade	AC55047	1
48	Piston Rod	AC55048	1
49	Roller Pin	AC55049	2
50	Lower Jaw	AC55050	1
51	Feeder Arm	AC55N051	1
56	Washer	AC01056	2
57	Nut	AE01006	2
58	Screw	AC02080-1	2
59	Inlet Bushing	AC01059	1
64	Screw	AC55064	1
67	Nut	AC01067	2
68	Pusher	AC55N068	1
69	Stop Ring	AC55069	1
70	Spring	AC01070	1
72	Magazine base	AC55072	1
73	Magazine	AC55N073	1
74	Screw of Jaws	AC55074	2
75	Magazine Spring	AC55075	1
76	Magazine Shoe	AC55076	1
77	Roll Pin	AC55077	2
79	Washer	AC55079	2
86	Plate Screw	AC11M086	1
99	O-Ring	AF01012	1
201	Feeder Guide Rail & Pusher Spring Assy	AC55201	1
202	Piston Rod Assy.	AC55202	1
203	Frame Assy.	AC55203	1
204	Feeder Guide Rail Complete	AC55N204	1
205	Pusher Assy.	AC55N205	1
206	Magazine Assy.	AC55N206	1
208	Throttle Valve Spacer Assy.	AC55208	1

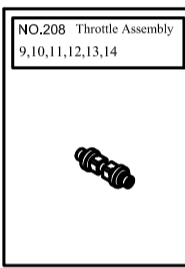
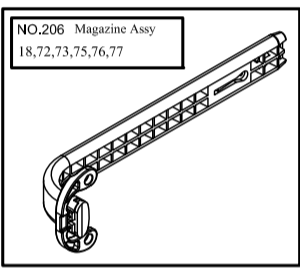
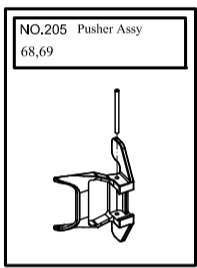
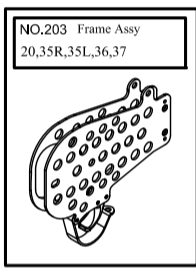
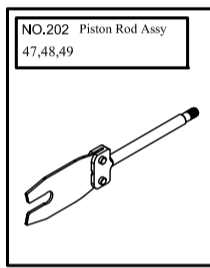
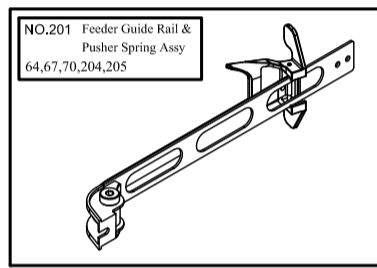

## RECOMMENDED SPARE PARTS LIST

ITEM	DESCRIPTION	PART NUMBER	Q'TY
29	O-Ring	AC41029	1
30	Piston	AC41030	1
40	Upper Jaw	AC55040	1
44	Latch Spring	AC55044	1
45	Latch	AC55045	1
50	Lower Jaw	AC55050	1
70	Spring	AC01070	1
202	Piston Rod Assy.	AC55202	1

## PERIODIC MAINTENANCE

### 1. Keeping clean of the tools

Do not set tools at the place where will get damage easily. Please keep from dust and humidification. Putting the tool in proper temperature is very important when the tool does not be used for a long time.

### 2. Cleaning the obstacle inside of tool

After using tools, please clean any obstacle blocking in JAWS (#40, #50). Keeping the tools clean is better.

### 3. Putting down tools lightly

After work, please put tools down lightly to avoid damaging the body and the magazine of tool.

### 4. Lubrication

To insure long, trouble-free service, we recommend air line lubricators and Filter Units for proper lubrication and clean, dry air. A good grade of oil that emulsifies in water is recommended for air tools.

### 5. Manual oiling

Although the jaws and other moving parts of the tool do need to be oiled, periodic oiling in small amounts may increase the serviceable life of the tool that receives heavy use. On a daily basis, place 4 -5 drops of light non-detergent oil into the inlet fitting where the supply line connects on the bottom of the handle.

## THE WAYS OF ELIMINATING SIMPLE BREAKDOWN

### ◆ AIR LEAK

#### A. Motionless position and the front leak

1. The part No.16 Front Valve Seat is not locked deep enough.
2. The part No.59 inlet is not closed enough but it would not affect any operation.

#### B. Motion position and the front leak

1. Part No.5 Rear Valve Seat is locked too deep.
2. The inlet No.59 is not closed enough but it would not affect any working.

### ◆ No working or stick of the trigger

1. The parts No.5 and No.16 are locked too deep to make assembly No.208 immovable.
2. Lacking for maintenance and getting rusty on assembly No.208 which is immovable.
3. The part No.29 O-Ring is worn and torn or part No.30 is loosened.
4. The part No.17 Throttle Stem could not bounce out which may be stuck by part No.16 with consolidation glue.

### ◆ The C-Rings may spurt out during operation.

1. Jaws of the tool are too tight. The part No.41 Jaw Bushing is worn and torn.
2. The jaws of tool are not smooth and hit on a C-Ring.
3. The C-Rings are with bad quality or not suitable on the tool.

### ◆ The ring is not made a good shape from the machine.

1. The jaws are broken.
2. The assembly #202 is broken or worn.
3. The staple is not good enough or not fit on the machine.

## WARNING

- ◆ Always read tool manual before operating.
- ◆ Do not point the tool at anyone.
- ◆ Keep hands and clothing away from the front of Jaws of the tool and away from all moving parts. Injury may result. Failure to follow these precautions may result in serious injury.
- ◆ Never actuate tool when loading, accidental injury may occur.
- ◆ Keep others at a safe distance from the tool while the tool is in operation as actuation occurs, possibly causing injury.
- ◆ Always wear safety glasses while operating or while in the vicinity of a tool in operation.
- ◆ Operate tool in an unobstructed work area.
- ◆ Air pressure should be maintained at 90-110 PSI(6-7 bars) using 1/4"(6.35mm) ID air hose. Higher pressures will not increase the operating speed of the tool and may cause damage to it.
- ◆ Do not use bottled gases such as oxygen, hydrogen, carbon dioxide or other combustible gasses.
- ◆ Disconnect air supply before servicing.

## LIMITED WARRANTY

Ann-Chain Enterprise warrants that the Pneumatic C-Ring tool is free from Defects in material and workmanship under normal use, within half year from the date of purchase, in the country of purchase. The warranty is extended to the original purchaser only. All parts except the consumable parts are warranted for half year from date of purchase and will be replaced if the sole judgment authorized service center. They should be deemed defective over and above that considered to be normal wear.

This tool is compliant with or conforms to EN 792-13



**ANN-CHAIN ENTERPRISE CO., LTD.**

No.65-5, Lane 540, Yoan-Fong Rd., Chang Hua City, Taiwan

TEL: 886-4-7521297 FAX: 886-4-7521293

Web Site: [www.ann-chain.com](http://www.ann-chain.com)

E-mail: [annchain@ms8.hinet.net](mailto:annchain@ms8.hinet.net)